

LED OBSTACLE LIGHTS

POL 10 | POL 32



LED obstacle lights, AVV-approved, compliant to ICAO, Annex 14, Volume 1, Chapter 6.

- Omnidirectional light with a radiation angle of 360° for operation at night and at twilight (night identification of aviation obstacles).
- 2 in 1: optional completely redundant construction of LED, electronics and power supply in one housing. A 2nd light is therefore not necessary.
- Optional automatic switching over to standby light in case of error.
- Integrated function monitoring with potential-free fault contact.
- Extremely long service life of over 50,000 hrs., hence maintenance-free.
- Optionally equipped with mounting-friendly plug contact.



POL 10



protection system



operating temperature



redundant



PRODUCT		POL 32			POL 10	
DATA						
Rated voltage		115 / 230 V	48 V	12 / 24 V	115 / 230 V	48 V
		AC 50 60 Hz	DC	DC	AC 50 60 Hz	DC
Operating range		85–265 V	40–57 V	9.6–28.8 V	85–265 V	40–57 V
Current consumption, determined arithmetically	115 V	96 mA			60 mA	
	230 V	45 mA			40 mA	
	48 V		270 mA			180 mA
	24 V			430 mA		350 mA
	12 V			800 mA		600 mA
Fault contact	NC	max. 230 V, 80 mA				
PRODUCT		POL 32-M		POL 10-M		POL 10-M-RA
Operating mode		continuous light				
Light source		LED array (red)			2x LED array (red)	
Version		monitored		monitored		monitored, redundant
Activation of standby light in case of error by means of					automatic switching	
Light intensity (DIN 5037)		32 cd		18 cd		
Beam angle		vertical approx. ±35 °, horizontal 360 °				
Operating temperature		–40 °C ... +55 °C				
Storage temperature		–40 °C ... +70 °C				
Relative humidity		100 %				
Protection system (EN 60529)		IP 68				
Service life of the light source		>50,000 hrs				
Material	lens	polycarbonate (PC)				
	base	polybutylene terephthalate (PBT)				
Mounting		direct mounting				
Connecting terminal		0.5–1.5 mm ² fine wire – H05(07)V-K; 0.5–2.5 mm ² single wire – H05(07)V-U				
Weight		approx. 750 g				
Approvals		ICAO		ICAO / AVV		ICAO / AVV

DIMENSIONS

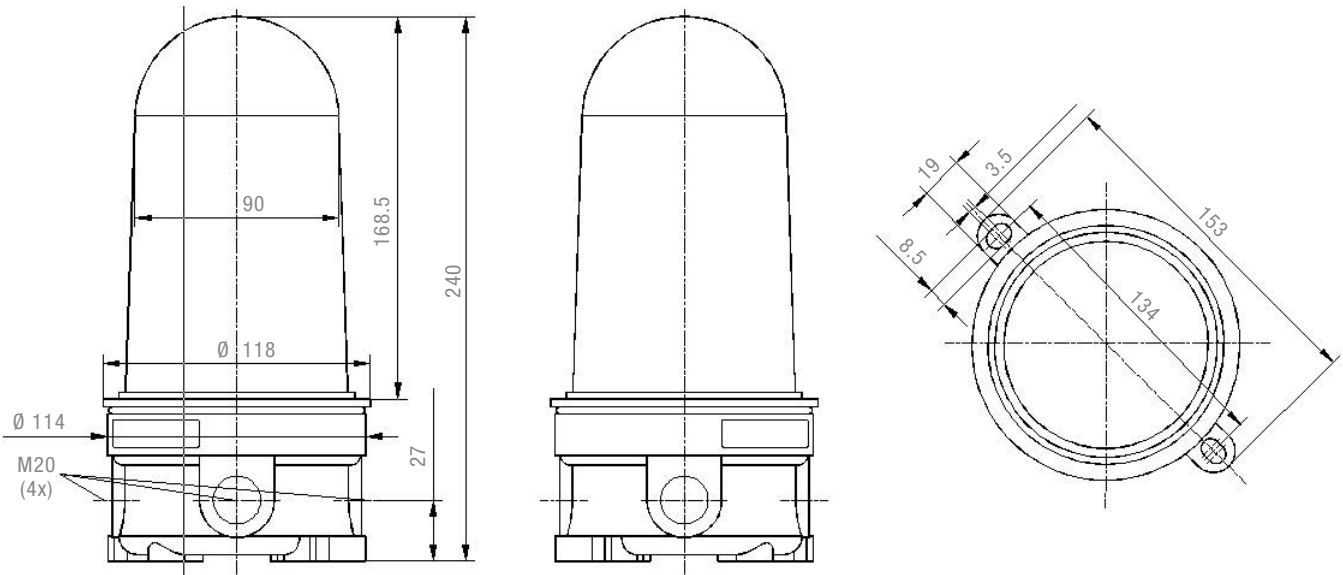

CONNECTION DIAGRAM

POL 32-M

POL 10

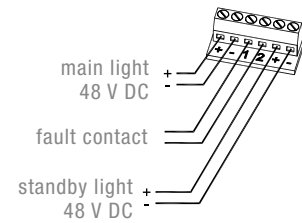
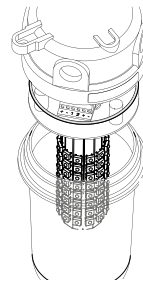
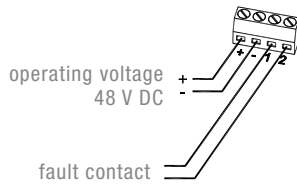
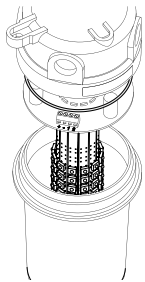

ARTICLE NO.	POL 32-M	POL 10-M	POL 10-M-RA
RATED VOLTAGE			
115 / 230 V AC	21105681005	21105641005	21105641010
48 V DC	21105661005	21105651005	21105651010
12 / 24 V DC	21105671005	21105631005	21105631010

CONFORMITY TO STANDARDS

The lights complies with the requirements of ICAO, Annex 14, Volume 1, Chapter 6. The lights are approved in Germany in accordance with the General Administrative Rules for the Identification of Aircraft Obstructions (AVV).

